

Chapter 1 Introduction

The **PH-855** series is an apartment entrance control system comprising Audio and Video. Manufacture superior quality and reliable products always our top objective. However, a qualified technician will ensure the system is installed and maintained properly for lasting usage.

Some points for attention before installation:

- 1) Ensure all wiring are properly terminated correctly into connectors.
- 2) Recommend cable specifications: **RG59 or RG11 for video signal**, **min.20AWG for control signal & min. AWG18 for monitor DC power wire**.
- 3) Ensure system cables are separated from high voltage power cables or television cables(cable TV).

Chapter 2 Precautionary Measures before Installation

- 1) Take care of monitors carefully and avoid dropping and hard knocking against it. This is to ensure the picture tube and PCB are not cracked from shock.
- 2) System cables are separated from power cables or cable TV. This is to ensure there is no interference that may affect the performance. Distance between the **855C5 (C10)-855Ma** should not exceed 100 meters. Important: Make sure a high quality voice, wire#2 and wire #3 should be twisted.
- 3) The **PH-855C5** is weatherproof. The base box is also waterproof if it is to be installed near sea or very windy areas. To inspect there is no water left behind from rain or construction before finish wiring in camera.
- 4) Equipment can operate between -20 degree C and +50 degree C.

Chapter 3 Model Items

Items: **PH-855C5 = 1 pc**

PH-855Ma / PH-855M3 = It depends upon user's request. The max. quantity 10 pcs.

2 kinds of pre-boxes for **PH-855C5**:

Flush Type: Dig a hole then inset the wall.dimensions:28.5x10x6 cm

Surface Type: Install the wall directly.dimensions:32.5x12.5x5 cm

- 1.Installation by 4 signal wires($\geq 1.0\text{mm}$)+1 coaxial cable(RG59-75ohms)+2 AC power wires.
- 2.Turn the switch on the position 75-OFF in the back part of all monitors except the furthest one. Measure the resistance between shield and wire with a multimeter. The ohm value must be around 75 to 80 Ohms.
- 3.Monitor Programming: Press the key(S1) in the back part of monitor until you hear a beep. You have 30 seconds to press the key(on SD-855C5) call the apartment monitor. The apartment monitor will ring and receive code.

4.Trouble Shooting

PH-855Ma monitor

Pin-1: VIDEO DC 0V

Pin-2: GND

Pin-3: OFF-0V, ON-1-3 V (DC)

Pin-4: OFF-0V, ON-6.5 V (DC)

Pin-5: OFF-0V, Press call button 1-3V (DC)

Pin-6: OFF-0V, Pick up the handset 1.5V (DC), Press call button 6.5V (DC)

PS. Don't connect pin-6 if no need extension in the same apartment.

PH-855C5 camera

Pin-1: VIDEO output

Pin-2: GND for video and signal control

Pin-3: OFF-0V, ON-1-3 V (DC)

Pin-4: OFF-0V, ON-6.5 V (DC)

Pin-5: OFF-0V, Press any button: 9V-11V (DC)

Pin-6: DC +15V input

Pin-7: GND for power

Pin-9 & Pin 10: for door release

PH-855C10 camera

Pin-1: VIDEO output

Pin-2: GND for video and signal control

Pin-3: OFF-0V, ON-1-3 V (DC)

Pin-4: OFF-0V, ON-6.5 V (DC)

Pin-5: DC+15V Input

Pin-6: GND for power

Pin-7 & Pin-8: for door release

PH-855C3 Door Bell with CCD

Pin-1: OFF-0V, ON 1.5V (DC)

Pin-2: GND

Pin-3: DC +12V-18V Input

Condition 1: voice normal but no picture

Reason: video cable short

Trouble shooting: inspect video cables & video wire connectors

Condition 2: picture normal but no voice

Reason: wire#3 faulty or short

Trouble shooting : inspect wire#3

Condition 3: no calling sound or not enough loud

Reason: volume knob turns to wrong position

Trouble shooting: turn the volume to the clockwise direction

Condition 4: camera can't call monitor

Reason: a) wire#3 faulty or short

b) no terminal resistor

c) improperly install terminal resistor

d) set a wrong code

trouble shooting: a) inspect wires

b) install terminal resistor

c) adjust resistor

d) re-set the code

Condition 5: no monitoring function in monitor

Reason: a) no power on

b) wire #4 short

Trouble shooting: a) inspect power source

b) inspect wire #4

Condition 6: monitoring function in monitor is normal, no voice, no picture & LED Lights on

Reason: a) no power in camera

b) wire #4 short

Trouble shooting: a) inspect the power in camera

b) inspect wire #4

Condition 7: door open is fail

Reason: a) door lock is faulty

b) a wrong wire connection in 3-pin cable which is for connecting door lock

Trouble shooting: a) inspect door lock

b) inspect wire arrangement

Condition 8: monitoring is fail

Reason: keep 6.5V in wire#2 & wire#4

Trouble shooting: inspect the connecting wire of **PH-855M** and find voltage source

If there is any question, please contact our agent in your city or us directly.

PH-855C5 The Keyboard Camera

Front-Cover View

Front View

Rear View

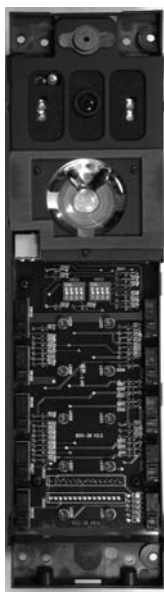

Specifications:
 Power Source: DC 15V via PH-P7
 Resolution: 380 TV lines
 IRIS system: Automatic
 Camera: 1/3" CCD Type
 Dimension: 32cm X 12cm X 6cm.
 Packing:
 G. W.: 1.5 kg.
 0.13 cubic feet.

Screws
 Screws
 5 ~ 10 Residents are Available

PH-855C10 The Camera

Front View

Rear View



1 ~ 4 Residents are Available
 KeyPad

Specifications:
 Power In: by PH-P7
 1 ~ 4 Residents are Available
 Resolution: Colour- 300 TV lines,
 B/W- 360 TV Lines
 Lens: Auto; pin hole lens
 CCD: 1/3" Colour or B/W CCD
 Min. illumination: Colour-0.2lux w/4 pcs LEDs
 B/W-0.2lux (w/6pcs Infrared IR)
 Dimensions: 183mm x 100mm x 25mm
 Packing:0.10 cuft
 Weight: 1.0 kg
 No need Prebox
 Stainless Case + Back light Keypad

PH-855Ma The Monitor

Front View

Rear View



Unlock
 Intercom
 Guard
 On/Off(MONITOR)
 DC IN
 S1 SW

Specifications:
 Power Source: AC In
 CRT: 4" b/w flat tube
 Resolution: 500 TV lines
 Calling Tone: Ding-Dong
 Display Time: pick up the handset 3 mins.
 hang up the handset 30 sec.
 Power Consumption: Standby--0.2W;
 Operating--Max.8W
 Wiring: 2-wire non-polarity
 Dimension: 250mm X 210mm X 45mm.
 Packing:0.3 cuft
 Weight: 1.5 kg

Setting **PH-855Ma (PH-855M3)** resident number procedures:

1. Press **S1 switch** on the rear side of Monitor until there is "bi bi" sound, then press one button of **PH-855C5 (or C10 or K2)**. The Monitor will be power on and there is "Ding-Dong, Ding-Dong" sound twice to confirm the setting is successfully made.

PH-855K2 10 - 20 Button Keyboard

Front-Cover View

Front View

Rear View

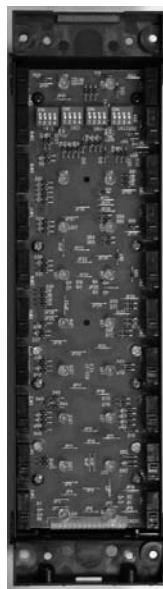

Specifications:

Power Source: Supply from 855C5
 Support from 10 to 20 Apartments
 LED illumination display
 Dimensions: 32cm X 12cm X 6cm.
 Packing:
 G. W.: 1.5 kg.
 0.13 cuft.

10 ~ 20 Residents are Available

PH-P6 Power Supply



Specifications:

Power Source: AC in
 Power Out: DC16.5 - 18V (2.5A)
 DC12V (300mA)
 Dimensions: 160cm X 80cm X 120mm
 Packing:
 G. W.: 2.0 kgs
 0.08 cuft.

PH-P7 Power Supply



Specifications:

Power Source: AC100-240V 47-63HZ
 Output: DC15V/ 1.0A
 Dimensions: 54X102X36 mm
 N.W.: 115 gs
 Dual Purpose fixed way: European type of
 Din Rail or hangings type
 Separated connectors AC / DC
 When output LED indicator off: Fuse open
 No need to dismantle from cover, you can
 change fuse easily
 It's a convenient size (115 g / 54x102x36 mm)

PH-855 System For 1 ~ 4 Apartments Installation Guide

Note: The Last PH-855Ma must turn the 75 ohms to on.

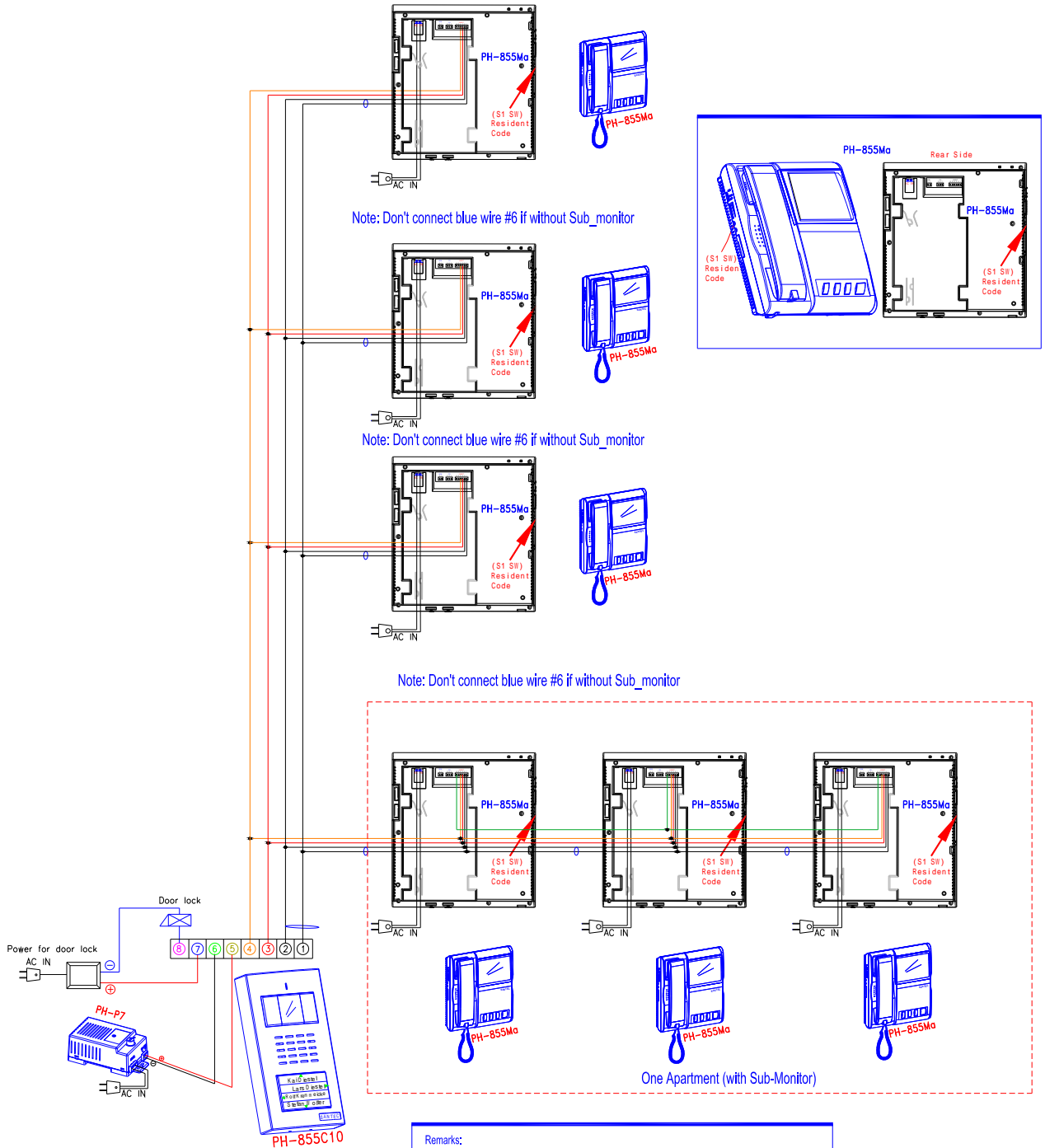

Remarks:

1. One Apartment Monitor capacity: 3 PH-855Ma
2. The wire specifications : AWG #20 at least
3. The Video Cable : RG59(75 ohms) at least.
4. PH-855Ma programming: Press the button (S1) on the rear side, until you hear a beep. You have 30 seconds to press the key (on PH-855C10). The PH-855Ma will be powered on and there is "Ding-Dong, Ding-Dong" sound twice to confirm the setting is successfully made.
5. PH-855 system don't supply the power for door lock. Please prepare an independent power for door lock.

NO: ph855-01-R1 DATE: 19 May 2004

PH-855 System For 5 ~ 10 Apartments Installation Guide

Note: The Last PH-855Ma must turn the 75 ohms to on.

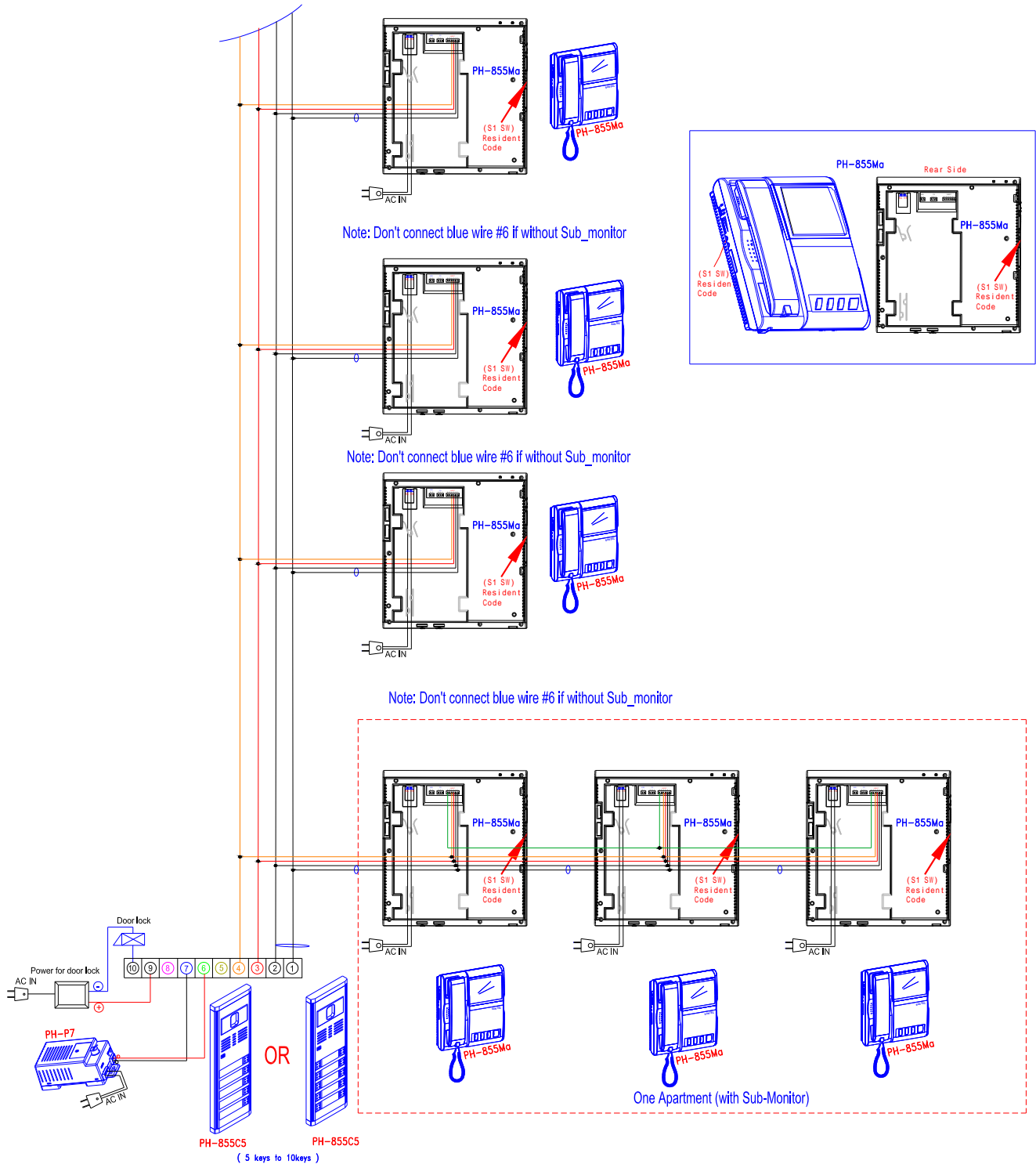

Remarks:

1. One Apartment Monitor capacity: 3 PH-855Ma
2. The wire specifications : AWG #20 at least
3. The Video Cable : RG59(75 ohms) at least.
4. PH-855Ma programming: Press the button (S1) on the rear side, until you hear a beep. You have 30 seconds to press the key (on PH-855CS). The PH-855Ma will be powered on and there is "Ding-Dong, Ding-Dong" sound twice to confirm the setting is successfully made.
5. PH-855 system don't supply the power for door lock. Please prepare an independent power for door lock.

NO: ph855-02-R1	DATE: 19 May 2004
--------------------	----------------------

PH-855 System For 11 ~ 30 Apartments Installation Guide

Note: The Last PH-855Ma must turn the 75 ohms on.

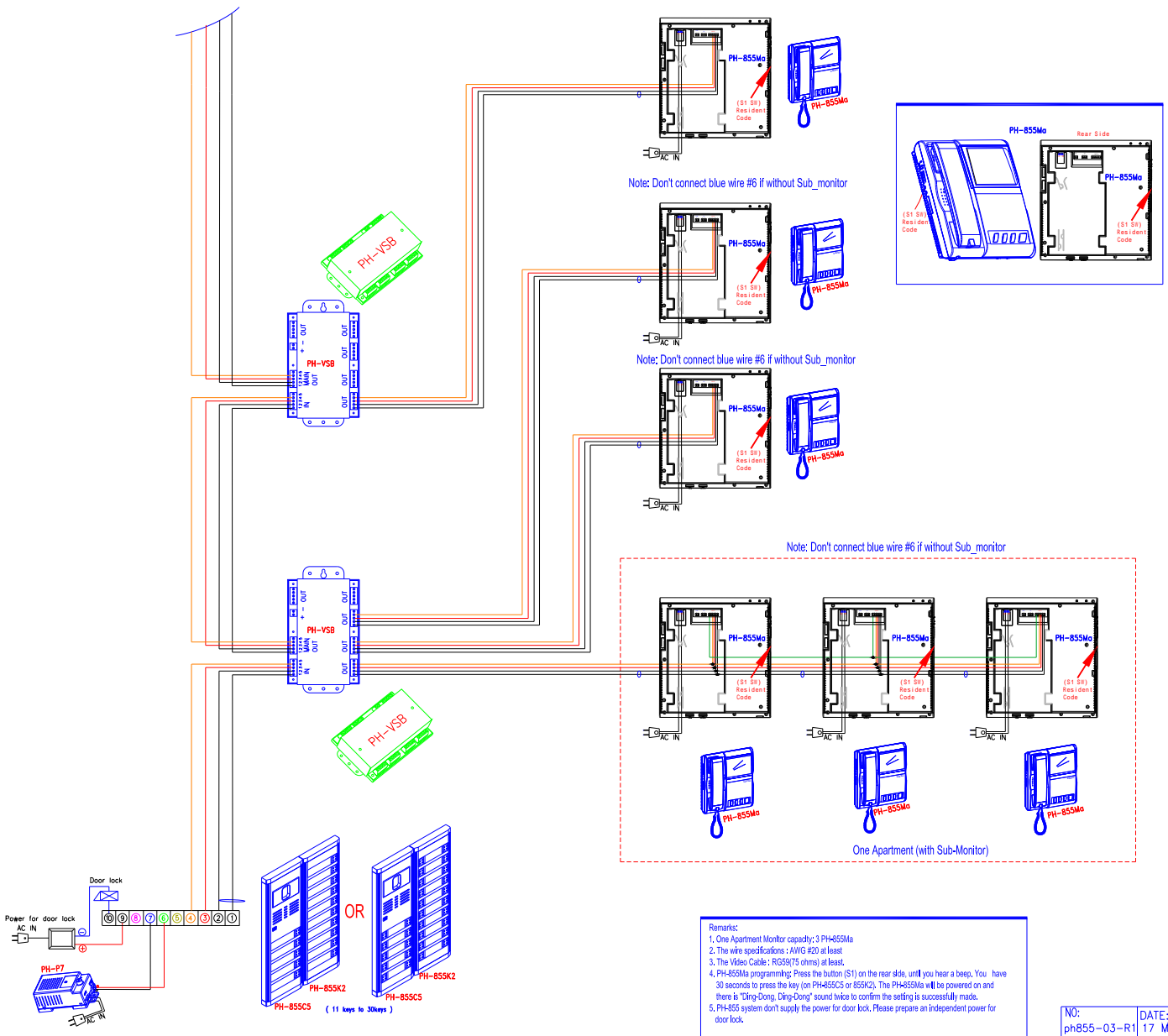

- Remarks:
1. One Apartment Monitor capacity: 3 PH-855Ma
 2. The wire specifications : AWG #20 at least
 3. The Video Cable : RG59(75 ohms) at least
 4. PH-855Ma programming: Press the button (S1) on the rear slide, until you hear a beep. You have 30 seconds to press the key (on PH-855CS or 855K2). The PH-855Ma will be powered on and there is "Ding-Dong, Ding-Dong" sound twice to confirm the setting is successfully made.
 5. PH-855 system don't supply the power for door lock. Please prepare an independent power for door lock.

NO: ph855-03-R1 DATE: 17 May 2004

